

W BILL OF MATERIAL

NO REQ'D	MARK NO	DESCRIPTION	LENGTH		REMARKS	SAW CUT
			FT	IN		
4	3PL1	PLATE				
4		PL 1/4 x 124 1/4	18	5		
16	3B1	BEAM				
16		W14 x 90	10	3 3/4		
PLAIN MATERIAL (No Sketch)						
8	3A1	L8 x 8 x 1/2	10	4		

FIELD BOLTS:
672 - 1 1/4"φ x 3 1/4" A325 BOLT W/H.H. NUT & WA.

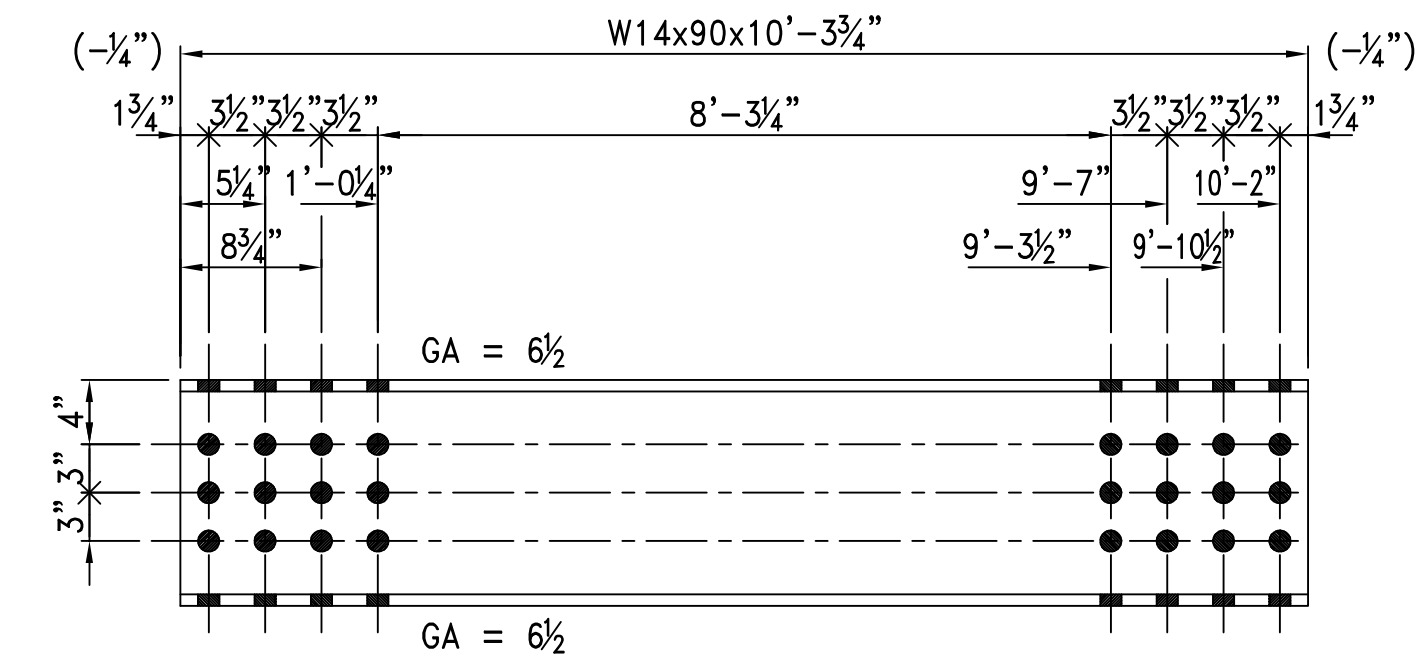

16 - BEAM - 3B1

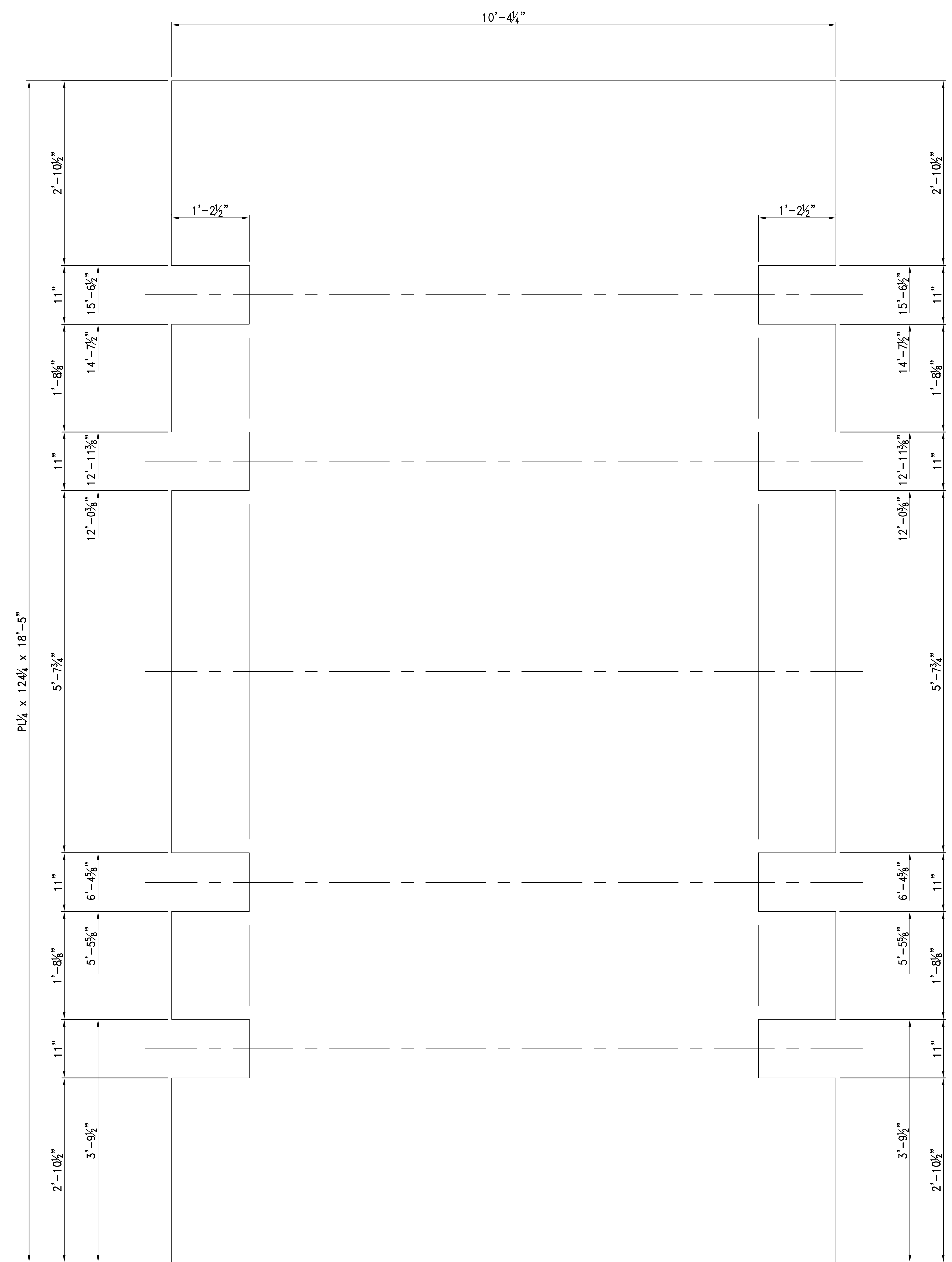

4 - PLATE - 3PL1

PAINT NOTE:
SHOP PRIME & PAINT YELLOW ENAMEL

FOR APPROVAL ONLY
 DATE: 04-13-11

4					
3					
2					
1					
REV	DESCRIPTION	DATE	SHOP NOTES	PROJECT	DRAWING NO.
			MAT'L A36 U.N. OPEN HLS. 1 3/16"φ U.N. WELDING E70XX PAINT SEE NOTE	ArcelorMittal USA - BURNS HARBOR CASTER No. 2 TUNDISH PIT COVER SHOP DWGS. g.c. ArcelorMittal USA	3
			JOB NO. S11022	DRAWN BY RAV DATE 04/07/11 CHK'D BY	

W WILSON IRON WORKS, INC.
1150 EAST SUMMIT ST.
CROWN POINT, IN
(219) 663-7900 - 769-8686